

BOS-21

Spherical pillow block bearing with LBM dry bush

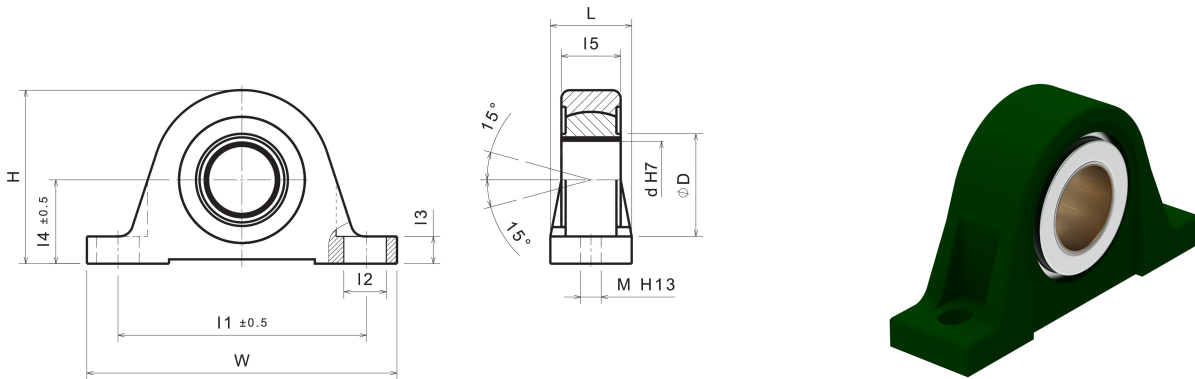

Product discription:

Spherical pillow block bearing with LBM dry bush

Article properties:

Base Material	Steel
Self-lubricating	Yes
Lubricant	PTFE lubrication layer
Surface Pressure P	100 N/mm ²
Sliding speed v	15 m/min
P*v-value	150 N/mm ² x m/min
Operating temperature	-200°C / +280°C

Variants:

Articlenumber	Article name	Inner diameter d	Outer diameter D	Width W	Length L	Height H	I1	I2	I3	I4	I5	M (DIN EN 20273)	Max. load (Housing) (kN)
63521010	BOS-21-10	10	33,3	102	25	56	76	13	10	28,6	15	2xM8	4,32
63521012	BOS-21-12	12	33,3	102	25	56	76	13	10	28,6	15	2xM8	4,32
63521015	BOS-21-15	15	33,3	102	25	56	76	13	10	28,6	15	2xM8	4,32
63521020	BOS-21-20	20	39,7	124	32	65	95	16	13	33,3	20	2xM10	7,7
63521025	BOS-21-25	25	39,7	124	32	65	95	16	13	33,3	25	2xM10	7,7
63521030	BOS-21-30	30	51	159	41	81	122	22	16	41,3	30	2xM12	9,55
63521035	BOS-21-35	35	60,3	159	48	102	137	22	16	49,2	35	2xM12	1,73
63521040	BOS-21-40	40	60,3	183	48	102	137	22	16	49,2	40	2xM12	1,73
63521045	BOS-21-45	45	73	183	54	113	152	22	16	54	45	2xM12	2,3
63521050	BOS-21-50	50	79,3	194	57	122	168	22	19	61,9	50	2xM16	2,5
63521055	BOS-21-55	55	83	214	64	135	197	22	22	66,7	55	2xM16	3,05
63521060	BOS-21-60	60	83	251	64	135	197	22	22	66,7	60	2xM16	3,05
63521065	BOS-21-65	65	83	251	64	135	197	22	22	66,7	60	2xM16	3,05
63521070	BOS-21-70	70	89	251	70	143	200	22	25	71,4	65	2xM16	2,8
63521075	BOS-21-75	75	89	254	70	143	200	22	25	71,4	65	2xM16	2,8
63521080	BOS-21-80	80	108	254	89	175	235	27	32	87,3	80	2xM20	4,55
63521085	BOS-21-85	85	108	295	89	175	235	27	32	87,3	80	2xM20	4,55
63521090	BOS-21-90	90	130	330	102	206	279	30	32	101,6	80	2xM20	7,45
63521100	BOS-21-100	100	130	330	102	206	279	30	32	101,6	80	2xM20	7,45